

CLARKE®



HEAVY DUTY WORKBENCH Model CWB1250

0107

Thank you for purchasing this CLARKE Heavy Duty Workbench, which, if treated with care and respect, will give years of reliable and satisfactory service.

Guarantee

This product is guaranteed against faults in manufacture from 12 months from purchase date.

Keep your receipt as proof of purchase. This guarantee is invalid if the product has been abused or tampered with in any way, or not used for the purpose for which it was intended. The reason for return must be clearly stated. This guarantee does not affect your statutory rights.

Pre-Assembly check.

Unpack the components and lay out carefully. Referring to the parts list, ensure that all parts are present. If there are any deficiencies, immediately contact the dealer from where the product was purchased, or the Clarke International Parts Department on, 020 8988 7400. Assembly is quite straightforward and requires the use of a screwdriver and a 10mm spanner

Assembly

Note: When assembling, all screw heads should be on the outside of the cabinet.
IMPORTANT: DO NOT tighten any nuts until the cabinet is fully assembled.
The numbers in brackets refer to the item number on back page

- 1 Hold the top panel (2), on its edge so that the blind hole on the inside edge, at one end, which is used to locate the cupboard door swivel pin, is uppermost, facing you and to the right. FIG.1

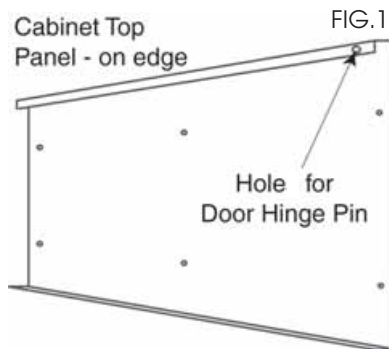

- 2 Ensuring the panels are correctly oriented attach the two side panels, (3 & 4) and the centre panel, (5), using the screws, nuts and washers provided. FIGS .2 & 3.

Remember - DO NOT tighten the nuts fully.

NOTE: The shelf supports attached to the end and centre panels should be facing each other, on the left side of the structure. FIG.3

The structure should now be resting on its side with the three panels facing you.

- 3 Attach the bottom panel in the same manner as in '1' above, i.e. by holding it on its edge with the blind hole on the inside edge uppermost. FIG.4.

Get an assistant to hold the door so that as the back panel is offered up, the swivel pins are entered in the two blind holes in the top and bottom panels. FIG.4

- 4 Turn the structure so that it rests on its front...i.e. the door, and attach the back panel (7).

REMEMBER - DO NOT tighten the nuts fully.

- 5 Whilst in this position, attach two legs, one to each corner, then turn the structure so that it rests on its back once again and attach the two front legs. FIG5

- 6 Turn the complete assembly on to its feet and rock it gently in order to align all parts and to ensure that no particular part is under stress. Ensure also that the legs are vertical and particularly, that the door is perfectly square in its recess. When completely satisfied, tighten all nuts and screws so far assembled.

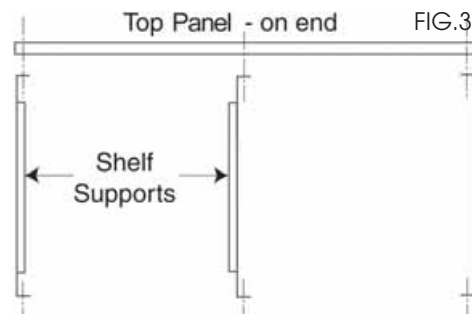
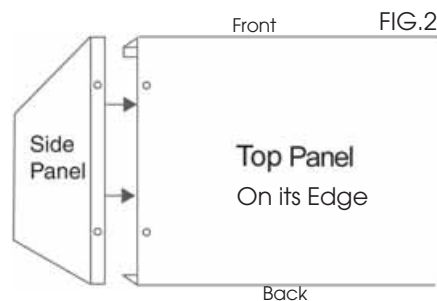

- 7** Using the empty carton as a clean base, place the worktop (1) face down - pre-drilled holes uppermost and attach the drawer guides (14) using the wood screws provided, ensuring they are tight. The drawer runners should face each other.

NOTE: The holes may need opening out slightly by very carefully drilling with a small drill - smaller than the root diameter of the woodscrew.

- 8** With the runners attached, turn the worktop over and bolt it securely to the base unit via the top of each leg. Ensure the drawer guides are at the front of the unit.

- 9** Insert the door lock into the hole in the door and secure firmly into place using the 'C' shaped washer.

- 10** Place the shelf on its rails.

- 11** Fully tighten any nuts not yet secure.

- 12** Assemble the drawer as follows:

The drawer comprises:

2 x Side panels, 1 x Front Panel, 1 x Back Panel, 1 x Bottom panel

- Having identified the various parts bolt the side panels to the front panel in the manner shown in the diagram below, then bolt on the back panel ...all screws should be finger tight.
- Drop in the bottom panel, and secure using the screws, washers and nuts supplied. Ensure the drawer is square before tightening all nuts.
- Attach the handle and tighten nuts.
- Slide the drawer into place, and your workbench is ready for use.

Top Cover - on end FIG.4

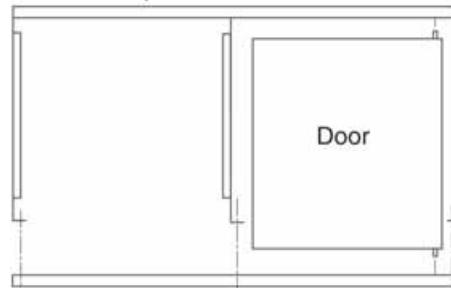

FIG.5

Top Cover - on end

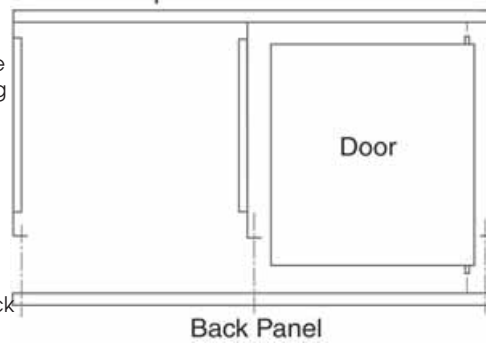
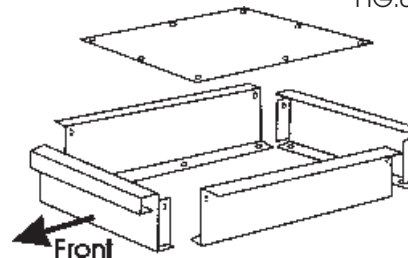

FIG.6



PARTS & SERVICE CONTACTS

For Spare Parts and Service, please contact your nearest dealer, or CLARKE International, on one of the following numbers.

PARTS & SERVICE TEL: 020 8988 7400

PARTS & SERVICE FAX: 020 8558 3622

or e-mail as follows:

PARTS: Parts@clarkeinternational.com

SERVICE: Service@clarkeinternational.com

Assembly Diagram

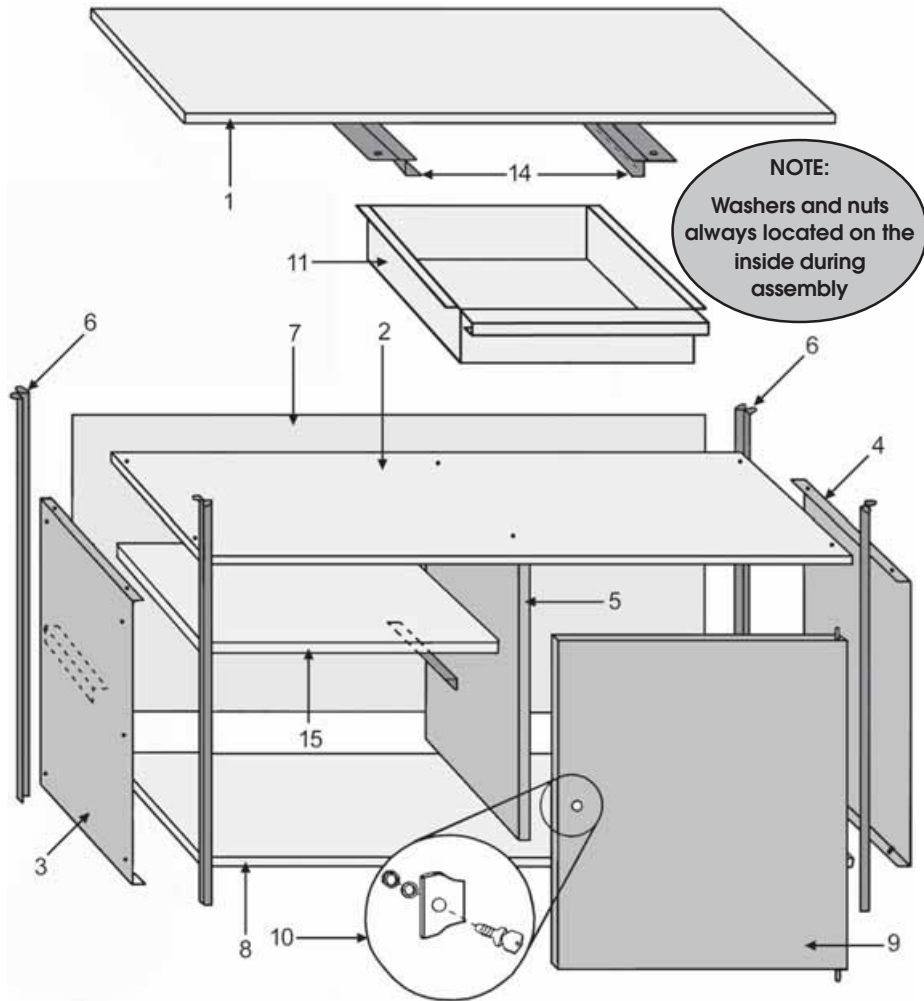

1 Worktop	RO125001	9 Door	RO125009
2 Top Panel	RO125002	10 Door Lock	RO125010
3 Side Panel (L)	RO125003	11 Drawer (5 Panels)	RO125011
4 Side Panel (R)	RO125004	14 Drawer Guide	RO125014
5 Centre Panel	RO125005	15 Shelf	RO125015
6 Legs	RO125006	- Screws, washers & nuts (set)	RO125016
7 Rear Panel	RO125007	- 21mm Wood screw -	RO125017
8 Bottom Panel	RO125008		