

Clarke®

air

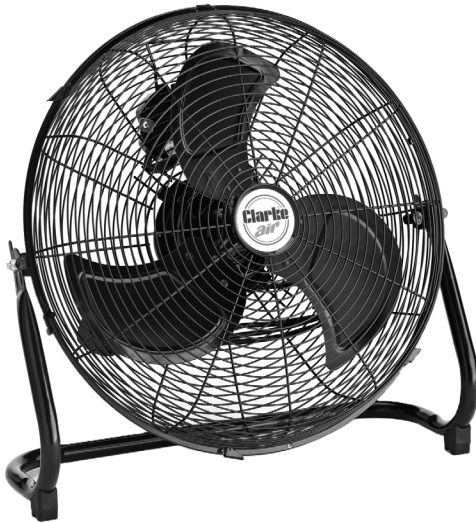

18 INCH HIGH VELOCITY FLOOR FAN

MODEL NO: CFF18B

PART NO: 3231520

OPERATION & MAINTENANCE INSTRUCTIONS



LS1112

INTRODUCTION

Thank you for purchasing this CLARKE 18 inch High Velocity Floor Fan.

Before attempting to use this product, please read this manual thoroughly and follow the instructions carefully. In doing so you will ensure the safety of yourself and that of others around you, and you can look forward to your purchase giving you long and satisfactory service.

GUARANTEE

This product is guaranteed against faulty manufacture for a period of 12 months from the date of purchase. Please keep your receipt which will be required as proof of purchase.

This guarantee is invalid if the product is found to have been abused or tampered with in any way, or not used for the purpose for which it was intended.

Faulty goods should be returned to their place of purchase, no product can be returned to us without prior permission.

This guarantee does not effect your statutory rights.

SPECIFICATIONS

MODEL CFF18B

Part No:	3231520	
Voltage:	230 V AC (50Hz)	
Wattage:	140 W	
Fan Speeds	3	
	Setting 1	950 RPM
	Setting 2	1080 RPM
	Setting 3	1250 RPM
Dimensions (L x W x H):	620 x 240 x 570 mm	
Weight:	6.2 kg	

ELECTRICAL CONNECTIONS



WARNING! Read these electrical safety instructions thoroughly before connecting the product to the mains supply.

Before switching the product on, make sure that the voltage of your electricity supply is the same as that indicated on the rating plate. This product is designed to operate on 230VAC 50Hz. Connecting it to any other power source may cause damage.

This product may be fitted with a non-rewireable plug. If it is necessary to change the fuse in the plug, the fuse cover must be refitted. If the fuse cover becomes lost or damaged, the plug must not be used until a suitable replacement is obtained.

If the plug has to be changed because it is not suitable for your socket, or due to damage, it should be cut off and a replacement fitted, following the wiring instructions shown below. The old plug must be disposed of safely, as insertion into a mains socket could cause an electrical hazard.



**WARNING! The wires in the power cable of this product are coloured in accordance with the following code:
Blue = Neutral Brown = Live Yellow and Green = Earth**

If the colours of the wires in the power cable of this product do not correspond with the markings on the terminals of your plug, proceed as follows.

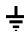
- The wire which is coloured **Blue** must be connected to the terminal which is marked **N** or coloured **Black**.
- The wire which is coloured **Brown** must be connected to the terminal which is marked **L** or coloured **Red**.
- The wire which is coloured **Yellow and Green** must be connected to the terminal which is marked **E** or  or coloured **Green**.

Plug must be BS1363/A approved.

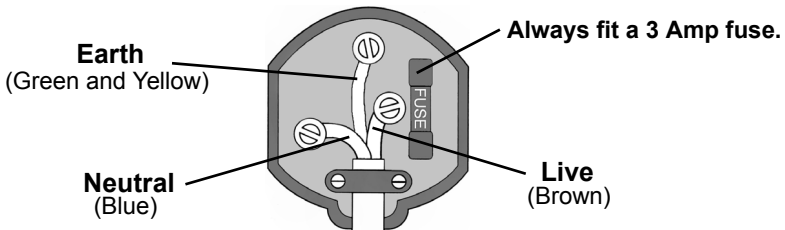

Ensure that the outer sheath of the cable is firmly held by the clamp

We strongly recommend that this machine is connected to the mains supply via a Residual Current Device (RCD)

If in any doubt, consult a qualified electrician. DO NOT attempt any repairs yourself.

SAFETY PRECAUTIONS

- **DO NOT** use in dusty environments.
- Indoor use only.
- **DO NOT** use in environments with high fumes from chemicals etc.
- **DO NOT** use as an extractor fan.
- **DO NOT** use in areas of high humidity/water vapour, i.e. bathrooms etc.
- **DO NOT** connect fan to ducting system.
- **DO NOT** cover the fan with clothing or any material that will restrict free airflow through the fan
- Never touch the blades with your hand or any object.

OPERATION

TILTING THE FAN

You can adjust the angle of the fan by holding the base and grill and tilting the fan to the required angle.

- Tighten the nuts on the side of the fan slightly if the fan will not stay in position

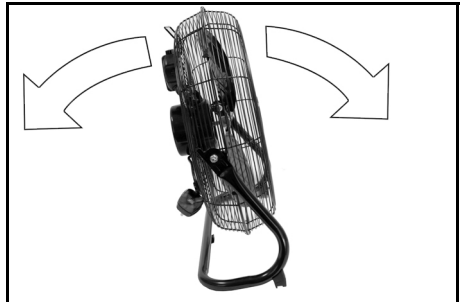

ADJUSTING THE SPEED

Press the relevant button to select the fan speed required

- Button 0 - Off
- Button 1 - 950 rpm
- Button 2 - 1080 rpm
- Button 3 - 1250 rpm

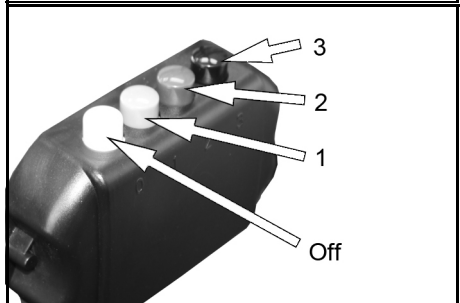

MAINTENANCE



WARNING: NEVER OPERATE THE FAN WITH THE FRONT GRILL REMOVED.

- The motor bearings are permanently sealed and do not require any additional lubrication.
- Have any repairs carried out by a suitably qualified person.

CLEANING

1. Disconnect the power cord from the mains.
2. Lift the guard clips and remove the single bolt and nut at the bottom of the guard.
3. Remove the guard carefully.
4. Wipe the fan blades with dry cloth.
 - Never use polish or any corrosive liquid that will damage the paint, metal or plastic.
 - Do not bend the blades!
5. Replace the guard so that the bolt holes in the front and rear guard line up and lock the guard securely before use.
 - Make sure that the guard clips are returned to the locked position.

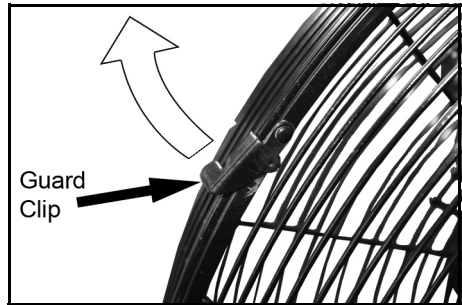

PART LIST AND DIAGRAM

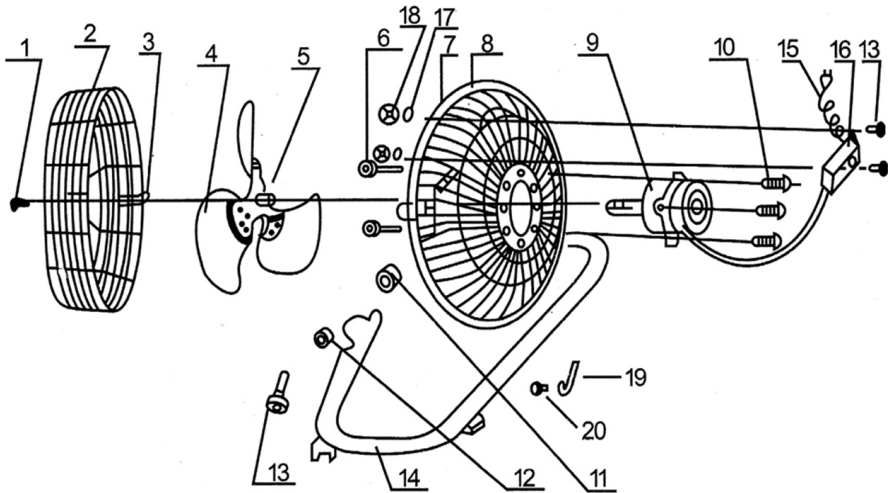

No	DESCRIPTION	PART NUMBER	No	DESCRIPTION	PART NUMBER
1	Screw	KWCFF18B01	11	Plastic Bearer	KWCFF18B11
2	Front Guard	KWCFF18B02	12	Locknut	KWCFF18B12
3	Guard Clips	KWCFF18B03	13	Screw	KWCFF18B13
4	Blade	KWCFF18B04	14	Tube Base	KWCFF18B14
5	Set Screw	KWCFF18B05	15	Power Cord	KWCFF18B15
6	Nut	KWCFF18B06	16	Control Box	KWCFF18B16
7	Square Bolt	KWCFF18B07	17	Washer	KWCFF18B17
8	Rear Guard	KWCFF18B08	18	Nuts	KWCFF18B18
9	Motor	KWCFF18B09	19	Carry Handle	KWCFF18B19
10	Screw	KWCFF18B10	20	Screw	KWCFF18B20

DECLARATION OF CONFORMITY



Clarke[®]
INTERNATIONAL

Hemnall Street, Epping, Essex CM16 4LG

DECLARATION OF CONFORMITY

This is an important document and should be retained.

We hereby declare that this product(s) complies with the following directive(s):

2004/108/EC *Electromagnetic Compatibility Directive.*

2006/95/EC *Low Voltage Equipment Directive.*

2002/95/EC *Restriction of Hazardous substances.*

The following standards have been applied to the product(s):

EN 55014-1:2006+A1:2009, EN 55014-2:1997+A1:2001+A2:2008, EN 61000-3-3:2008,

EN 60335-2-80:2003 +A1:2004+A2:2009, EN 62233:2008, EN 61000-3-2:2006 +A1:2009 +A2:2009,

EN 60335-1:2002 +A11:2004 +A1:2004 +A12:2006 +A2:2006 +A13:2008

The technical documentation required to demonstrate that the product(s) meet(s) the requirement(s) of the aforementioned directive(s) has been compiled and is available for inspection by the relevant enforcement authorities.

The CE mark was first applied in: 2010

Product Description: High velocity black floor fan
Model number(s): CFF18B
Serial / batch Number: N/A
Date of Issue: 05/09/12

Signed:

J.A. Clarke
Director

A SELECTION FROM THE VAST RANGE OF

Clarke®

QUALITY PRODUCTS

AIR COMPRESSORS

From DIY to industrial, Plus air tools, spray guns and accessories.

GENERATORS

Prime duty or emergency standby for business, home and leisure.

POWER WASHERS

Hot and cold, electric and engine driven - we have what you need

WELDERS

Mig, Arc, Tig and Spot. From DIY to auto/industrial.

METALWORKING

Drills, grinders and saws for DIY and professional use.

WOODWORKING

Saws, sanders, lathes, mortisers and dust extraction.

HYDRAULICS

Cranes, body repair kits, transmission jacks for all types of workshop use.

WATER PUMPS

Submersible, electric and engine driven for DIY, agriculture and industry.

POWER TOOLS

Angle grinders, cordless drill sets, saws and sanders.

STARTERS/CHARGERS

All sizes for car and commercial use.

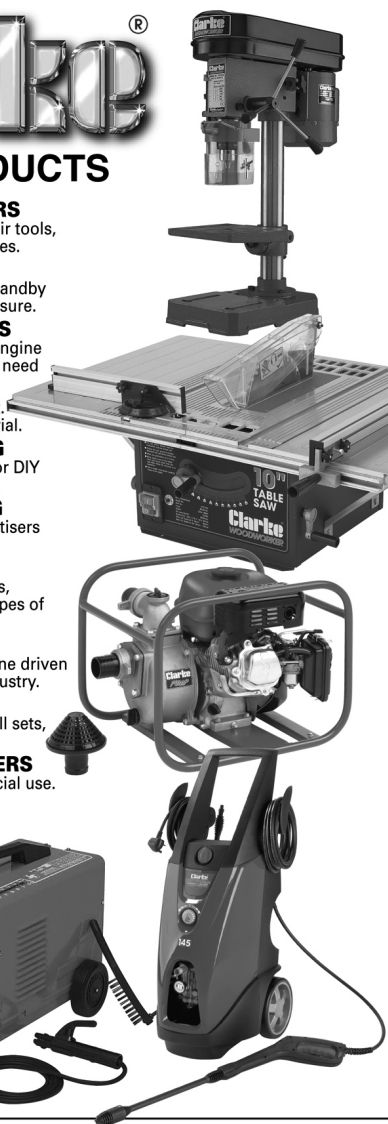

PARTS & SERVICE: 020 8988 7400

E-mail: Parts@clarkeinternational.com or Service@clarkeinternational.com

SALES: UK 01992 565333 or Export 00 44 (0)1992 565335

Clarke® INTERNATIONAL Hemnall Street, Epping, Essex CM16 4LG
www.clarkeinternational.com