

LASER[®]

Rear Suspension Tool

Ford – Focus

Instructions

4437

SAFETY PRECAUTIONS: ALWAYS

- Wear appropriate safety equipment.
- Refer to a reputable workshop manual and follow the detailed instructions relevant to the vehicle being serviced.
- Always ensure the car is securely supported by axle stands or ramps with the remaining wheels chocked and hand brake on.
- Prepare the existing bush joint before attempting to remove it.
- Clean off all rust, grime etc and prime with penetrating oil
- Leave the oil to soak in for quite a while before attempting to remove.
- Inspect the tool prior to use and replace worn and damaged parts.
- Lubricate the threads on the centre screw before and after use.
- Care should be taken to align the bush and housing correctly
- Do not apply excessive force
- Do not use with an impact wrench
- Use common sense and caution at all times.



5 018341 044374 >



www.lasertools.co.uk

Guarantee

If this product fails through faulty materials or workmanship, contact our service department direct on: **+44 (0) 1926 818186**. Normal wear & tear are excluded as are consumable items & abuse.



Distributed by The Tool Connection Ltd
Kineton Road, Southam, Warwickshire CV47 0DR
T +44 (0) 1926 815000 F +44 (0) 1926 815888
info@toolconnection.co.uk www.toolconnection.co.uk

Rear Suspension Tool

Ford – Focus

Rear Suspension Tool for the rear Trailing Arm Bushes on Ford Focus 1.4 | 1.6 | 1.8 | 1.8Di 1.8TDCi | 2.0 16v RS. This tool is designed to fit in situ saving time and money.

Removal

- 1 Remove shock absorber, lower mounting bolt, ABS brake sensor etc and wedge the lower arm in place to gain access to the bush.
- 2 To ensure the correct alignment is achieved mark the inner wing of the bush against the arm.
- 3 Lubricate generously the stud threads and bearing assembly before and during use.
- 4 To remove the old bush, assemble tool as shown in (Fig 1) using removal sleeve.
- 5 The tool should be pushing in to the centre from the outside (Fig 1)
- 6 Screw up the Main Drive Bar until the Thrust Bearing assembly makes contact with the bush.
- 7 Continue to tighten slowly using a 21mm spanner or ratchet on the hex end.
- 8 If the bush remains stubborn, re-lubricate and try again.
- 8 Reassemble the suspension ensuring the arm is correctly aligned.
- 9 Clean off tool and re-lubricate

Contents

- A Main Drive Bar
- B Thrust bearing Assembly
- C Removal sleeve (Silver)
- D Installing sleeve (Gold)

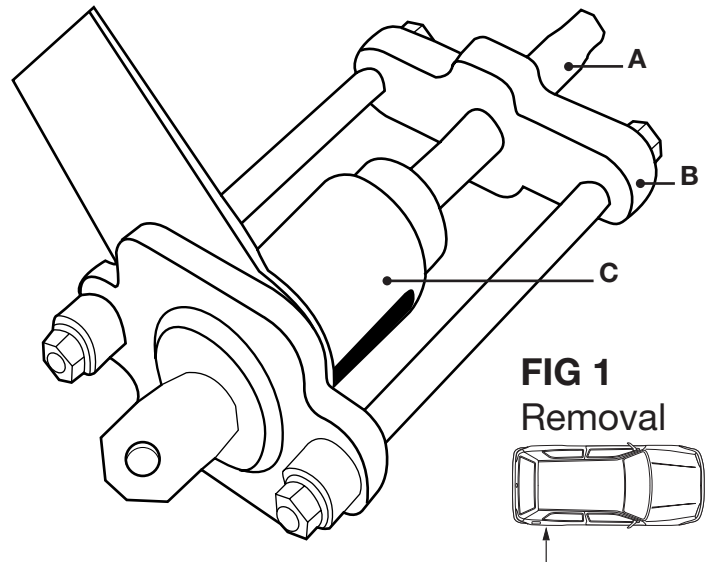

FIG 1
Removal

Installation

- 1 Re-assemble the tool using the installation sleeve (Fig 2)
- 2 Clean the bore of the arm and re-lubricate the Thrush bearing assy.
- 3 Position the slot on the installation tool facing towards the rear of the car. The tool should be pushing from the centre of the car to the outside (Fig 2)
- 4 Ensure the bush is aligned with markings taken before removal and the bottom edge of the installing sleeve corresponds with the contoured shape of the trailing arm.
- 5 Hand tighten as before until the Thrust Bearing contacts the new bush.
- 6 Tighten using the 22mm tool until the new bush moves into position.
- 7 Continue to tighten, maintaining alignment until bush is re-housed into pre marked position.

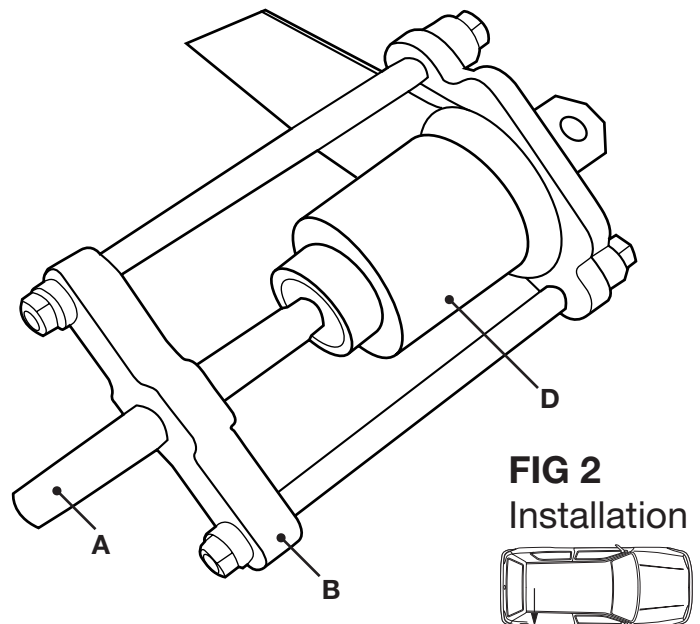

FIG 2
Installation