



# INSTRUCTIONS FOR 400A Lithium Jump Starter

Stock No. 15066 Part No. LJS120

**IMPORTANT:** PLEASE READ THESE INSTRUCTIONS CAREFULLY TO ENSURE THE SAFE AND EFFECTIVE USE OF THIS PRODUCT.



## GENERAL INFORMATION

These instructions accompanying the product are the original instructions. This document is part of the product, keep it for the life of the product passing it on to any subsequent holder of the product. Read all these instructions before assembling, operating or maintaining this product.

This manual has been compiled by Draper Tools describing the purpose for which the product has been designed, and contains all the necessary information to ensure its correct and safe use. By following all the general safety instructions contained in this manual, it will ensure both product and operator safety, together with longer life of the product itself.

All photographs and drawings in this manual are supplied by Draper Tools to help illustrate the operation of the product.

Whilst every effort has been made to ensure the accuracy of information contained in this manual, the Draper Tools policy of continuous improvement determines the right to make modifications without prior warning.

# 1. TITLE PAGE

---

## **1.1 INTRODUCTION:**

USER MANUAL FOR:

## **400A LITHIUM JUMP STARTER**

Stock no. 15066.

Part no. LJS120.

## **1.2 REVISIONS:**

---

Date first published July 2016

---

---

---

As our user manuals are continually updated, users should make sure that they use the very latest version.

Downloads are available from: <http://www.drapertools.com/manuals>

DRAPER TOOLS LIMITED

HURSLEY ROAD

CHANDLER'S FORD

EASTLEIGH

HAMPSHIRE

SO53 1YF

UK

WEBSITE: [drapertools.com](http://drapertools.com)

PRODUCT HELPLINE: +44 (0) 23 8049 4344

GENERAL FAX: +44 (0) 23 8026 0784

## **1.3 UNDERSTANDING THIS MANUALS SAFETY CONTENT:**

**WARNING!** Information that draws attention to the risk of injury or death.

**CAUTION!** Information that draws attention to the risk of damage to the product or surroundings.

## **1.4 COPYRIGHT © NOTICE:**

Copyright © Draper Tools Limited.

Permission is granted to reproduce this publication for personal & educational use only.

Commercial copying, redistribution, hiring or lending is prohibited.

No part of this publication may be stored in a retrieval system or transmitted in any other form or means without written permission from Draper Tools Limited.

In all cases this copyright notice must remain intact.

---

# 2. CONTENTS

---

## 2.1 CONTENTS

	<i>Page</i>	
1	TITLE PAGE	
	1.1 INTRODUCTION .....	2
	1.2 REVISION HISTORY .....	2
	1.3 UNDERSTANDING THIS MANUAL .....	2
	1.4 COPYRIGHT NOTICE .....	2
2	CONTENTS	
	2.1 CONTENTS .....	3
3	GUARANTEE	
	3.1 GUARANTEE .....	4
4	INTRODUCTION	
	4.1 SCOPE .....	5
	4.2 SPECIFICATION .....	5
	4.3 HANDLING & STORAGE .....	5
5	HEALTH & SAFETY INFORMATION	
	5.1 GENERAL SAFETY INSTRUCTIONS FOR JUMP STARTER .....	6
	5.2 CAUTION: RISK OF ELECTRIC SHOCK. DO NOT OPEN. ....	7
6	TECHNICAL DESCRIPTION	
	6.1 IDENTIFICATION .....	8
7	UNPACKING & CHECKING	
	7.1 PACKAGING .....	9
	7.2 WHAT'S IN THE BOX? .....	9
8	OPERATING INSTRUCTIONS	
	8.1 JUMP START CAR .....	10
	8.2 CHARGING USING USB LEAD .....	11
	8.3 LED LIGHT .....	11
	8.4 CHARGING THE JUMP STARTER UNIT .....	11
9	EXPLANATION OF SYMBOLS	
	9.1 EXPLANATION OF SYMBOLS .....	12
10	DISPOSAL	
	10.1 DISPOSAL .....	13
	DECLARATION OF CONFORMITY .....	ENCLOSED

# 3. GUARANTEE

---

## 3.1 GUARANTEE

Draper tools have been carefully tested and inspected before shipment and are guaranteed to be free from defective materials and workmanship.

Should the tool develop a fault, please return the complete tool to your nearest distributor or contact Draper Tools Limited, Chandler's Ford, Eastleigh, Hampshire, SO53 1YF. England. Telephone Sales Desk: (023) 8049 4333 or Product Helpline (023) 8049 4344.

A proof of purchase must be provided with the tool.

If upon inspection it is found that the fault occurring is due to defective materials or workmanship, repairs will be carried out free of charge. This guarantee period covering parts/labour is 12 months from the date of purchase except where tools are hired out when the guarantee period is 90 days from the date of purchase. The guarantee is extended to 24 months for parts only. This guarantee does not apply to normal wear and tear, nor does it cover any damage caused by misuse, careless or unsafe handling, alterations, accidents, or repairs attempted or made by any personnel other than the authorised Draper warranty repair agent.

Note: If the tool is found not to be within the terms of warranty, repairs and carriage charges will be quoted and made accordingly.

This guarantee applies in lieu of any other guarantee expressed or implied and variations of its terms are not authorised.

Your Draper guarantee is not effective unless you can produce upon request a dated receipt or invoice to verify your proof of purchase within the guarantee period.

Please note that this guarantee is an additional benefit and does not affect your statutory rights.

Draper Tools Limited.

## 4. INTRODUCTION

---

### 4.1 SCOPE

This Lithium jump starter has features, functionality, portability, ease of use, durability and safety making it a very practical auto accessory for more than just emergencies.

### 4.2 SPECIFICATION

Stock no. ....	15066
Part no. ....	LJ5120
Battery chemistry .....	LiCoO2
Battery capacity.....	35.5WH
Start current .....	200A
Peak current .....	400A
USB outputs.....	1x 1A
.....	1x 2.1A
Operating temperature .....	-20 to 60°C
Dimensions .....	30 x 78 x 174mm
Weight .....	0.386kg

Ensure this products peak amps 500A is same or greater than vehicles battery.

Please make sure the power of the jumpstarter is at least 50% before using.

Avoid excessive discharge power and reduce the service life of the device.

### 4.3 HANDLING & STORAGE

Care must still be taken when handling, starter as dropping this machine will have an effect on the accuracy. This machine is not a toy and must be respected.

The environment will have a negative result on its operation if you are not careful. If the air is damp, components will rust. If the machine is unprotected from dust and debris; components will become clogged: And if not cleaned and maintained correctly or regularly the machine will not perform at its best.

## 5. HEALTH & SAFETY INFORMATION

---

### **5.1 GENERAL SAFETY INSTRUCTIONS FOR JUMP STARTER**

**Connect the charger carefully.** Make sure the red clamp is attached to the battery positive terminal. The black clamp attaches to the negative. Do not reverse the clamps or allow them to touch each other.

**Refer to the vehicle manufacturers information.** Follow these instructions fully to make sure no damage occurs to the vehicle or it's equipment.

**Do not cover the charger.** Allow air to circulate around the charger to prevent over heating.

Use this jump starter at normal temperature, away from wet and hot conditions.

Keep the jump starter at dry place, far away from wet or corrosive materials.

**Do not tamper with this product.** Repairs and maintenance must be carried out by an authorized service agent. Only use genuine Draper spare parts. Do not modify this product in any way.

**Never attempt to charge non-rechargeable batteries.** Only charge lead acid batteries within the voltage and amp hour capacities of the charger.

**Never attempt to charge a damaged or distorted battery.**

**Do not start the car continuously,** leave at least 15 seconds between intervals.

Do not use the jump starter if power level is less than 10%, or it will harm the starter.

**Charge the starter for 3 hours or more,** before being used for the first time.

Children should be under adult supervision when using this starter, to avoid damage or potential harm.

## 5. HEALTH & SAFETY INFORMATION

---

### **5.2 CAUTION: RISK OF ELECTRIC SHOCK. DO NOT OPEN.**

**Caution:** Risk of electric shock. Do not open.

This appliance is supplied with a moulded 3 pin mains plug for your safety. The value of the fuse fitted is marked on the pin face of the plug. Should the fuse need replacing, ensure the substitute is of the correct rating, approved to BS1362 and ASTA or BS Kite marked.

ASTA 

BSI 

The fuse cover is removable with a small plain slot screwdriver. Ensure the fuse cover is replaced before attempting to connect the plug to an electrical outlet. If the cover is missing, a replacement must be obtained or the plug replaced with a suitable type.

If a replacement plug is to be fitted this must be carried out by a qualified electrician.

The damaged or incomplete plug, when cut from the cable should be disabled to prevent connection to a live electrical outlet.

This appliance is Class II<sup>†</sup> and is designed for connection to a power supply matching that detailed on the rating label and compatible with the plug fitted.

If an extension lead is required, use an approved and compatible lead rated for this appliance. Follow all the instruction supplied with the extension lead.

<sup>†</sup>Double insulated : This product requires no earth connection as supplementary insulation is applied to the basic insulation to protect against electric shock in the event of failure of the basic insulation.

# 6. TECHNICAL DESCRIPTION

---

## 6.1 IDENTIFICATION



- ① Power/Torch switch
- ② Torch lamp
- ③ Power indicator
- ④ USB5V/1A

- ⑤ USB5V/2.1A
- ⑥ Input 15V/1A
- ⑦ Jump start port



# 7. UNPACKING & CHECKING

## 7.1 PACKAGING

Carefully remove the product from the packaging and examine it for any sign of damage that may have happened during shipping. Lay the contents out and check them against the parts shown below. If any part is damaged or missing; please contact the Draper Helpline (the telephone number appears on the Title page) and do not attempt to use the tool.

The packaging material should be retained at least during the guarantee period: in case the machine needs to be returned for repair.

**Warning!** Some of the packaging materials used may be harmful to children. Do not leave any of these materials in the reach of children.

If any of the packaging is to be thrown away, make sure they are disposed of correctly; according to local regulations.

## 7.2 WHAT'S IN THE BOX?

As well as the starter; there are several parts not fitted or attached to it.



⑧ Padded carry case.

⑨ 4 in 1 multi purpose USB lead.

⑩ Smart jump leads.

⑪ Car charger lead.

⑫ Mains charger lead.

## 8. OPERATING INSTRUCTIONS

### 8.1 JUMP START CAR:

**NOTE:** Ensure this products peak amps 500A is same or greater than vehicles battery.

**NOTE:** Jump starting will be at its most efficient when the unit is fully charged and all four indicator bars are illuminated.

1. Using smart jump leads (10), in order connect RED positive clamp to positive terminal on car battery, then BLACK negative clamp onto negative terminal on car battery.

2. Once the clamps are attached then insert plug into jump starter (7).

3. Press button on side of smart jump leads box for 1 second.

4. Turn key to start car. (If the car does not start, wait 15 seconds and try again).

5. Once car has started pull the plug from the jump starter (7), then remove clamps from car battery.

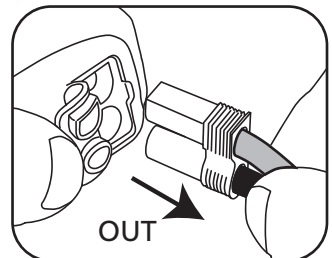
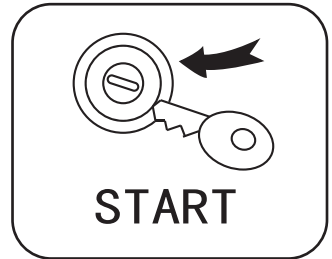
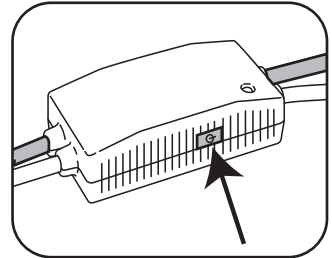
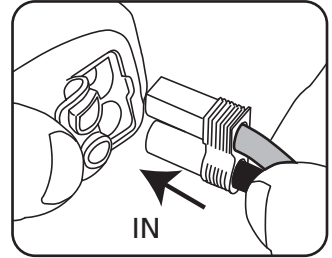
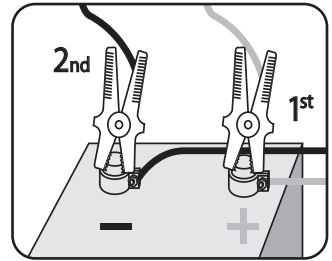

## 8. OPERATING INSTRUCTIONS

---

Apart from jump starting a car, this jump starter can also be used for charging a electrical device using USB leads.



Jump start  
a car



Charge cell  
phone/tablet



Charge  
camera/video



Charge  
game consoles

### 8.2 CHARGING USING USB LEAD.

Insert the USB charge cable (9) into either USB output ports USB 5V/1A (4) or USB 5V/2.1A (5), depending on the power needs for the device.

Insert other end the electrical device for charging.

Press (1) to begin.

### 8.3 LED LIGHT.

Hold the (1) (1) for 3 seconds to turn light on **constant**.

Press (1) again for a **slow flash**.

Press (1) again for **fast flash**.

Press (1) again to return beginning of cycle (**constant, slow flash, fast flash**).

At any time you wish to turn off light just hold (1) down for 3 seconds.

### 8.4 CHARGING THE JUMP STARTER

The jump starter can be charged by either the mains 230V plug (12), or the in car 12V charger (11), plugged into the Input 15V/1A port (6).

# 9. EXPLANATION OF SYMBOLS

---

## 9.1 EXPLANATION OF SYMBOLS



WEEE\*  
Do not dispose of Waste  
Electrical & Electronic Equipment  
in with domestic rubbish

\* Waste Electrical & Electronic Equipment.



Battery must be recycled  
or disposed of properly.



**LiCoO2**



Class II construction  
(Double insulated)



Warning!  
Read instruction manuals before  
operating and servicing this  
equipment.



# 10. DISPOSAL

---

## 10.1 DISPOSAL

- At the end of the machine's working life, or when it can no longer be repaired, ensure that it is disposed of according to national regulations.
- Contact your local authority for details of collection schemes in your area.

In all circumstances:

- Do not dispose of power tools with domestic waste.
- Do not incinerate.
- Do not abandon in the environment.
- Do not dispose of WEEE\* as unsorted municipal waste.



\* Waste Electrical & Electronic Equipment.





- **DRAPER TOOLS LIMITED,**  
Hursley Road, Chandler's Ford,  
Eastleigh, Hampshire. SO53 1YF. U.K.
- **Helpline:** (023) 8049 4344
- **Sales Desk:** (023) 8049 4333
- **General Enquiries:** (023) 8026 6355
- **Service/Warranty Repair Agent**  
For aftersales servicing or warranty repairs, please  
contact the Draper Tools Helpline for details of an  
agent in your local area.

YOUR DRAPER STOCKIST

KCMC0716

