

Clarke®



UNIVERSAL HUB/BEARING PULLER

Model No: CHT718

Part No: 1801718

USER INSTRUCTIONS

INTRODUCTION

Thank you for purchasing this CLARKE product. The kit may be used for installing seals and bearings into the hubs of most vehicles. It may also be used for pulling hubs where the wheel flange is drilled and tapped so that the road wheel is secured with bolts.

Please read and follow the instructions carefully. In doing so you will ensure the safety of yourself and others around you, and you can look forward to the product giving you long & satisfactory service.

Please keep these instructions in a safe place for future reference

KIT CONTENTS

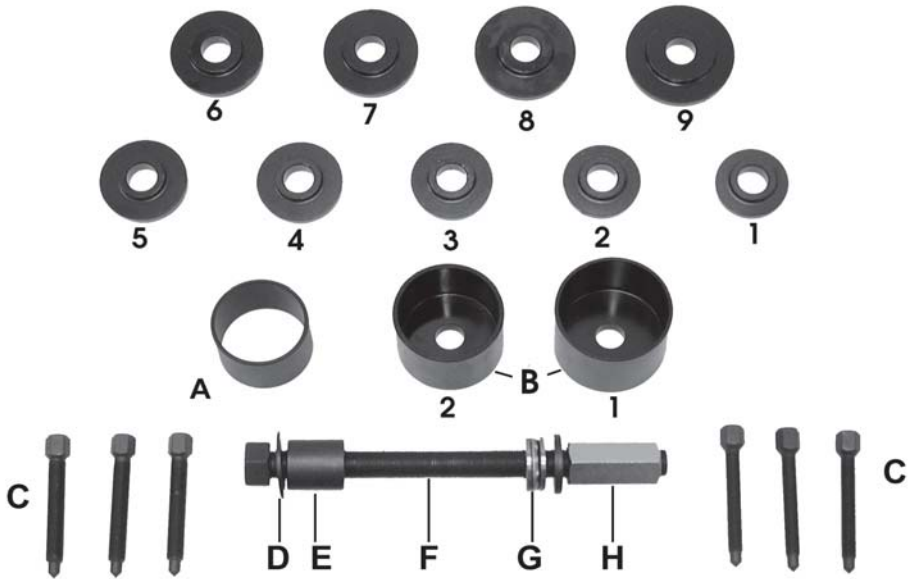

1	Disc - 55.5mm (2-3/16")	HTCHT71801
2	Disc - 59mm (2-11/32")	HTCHT71802
3	Disc - 62mm (2-7/16")	HTCHT71803
4	Disc - 65mm (2-9/16")	HTCHT71804
5	Disc - 66mm (2-19/32")	HTCHT71805
6	Disc - 71.5mm (2-13/16")	HTCHT71806
7	Disc - 73mm (2-7/8")	HTCHT71807
8	Disc - 78mm (3-3/32")	HTCHT71808
9	Disc - 84mm (3-5/16")	HTCHT71809

A	Sleeve 76mm (3")	HTCHT71810
B1	Cup- 86mm (3-13/32")	HTCHT71811
B2	Cup- 91mm (3-19/32")	HTCHT71812
C	Bolt M12 x 90	HTCHT71813
D	Flat Washer	HTCHT71814
E	Sleeve 36mm (1-7/16")	HTCHT71815
F	Centre Bolt	HTCHT71816
G	Thrust Washers	HTCHT71817
H	Long Nut	HTCHT71818

METHOD OF USE



WARNING: THE VEHICLE MUST BE PROPERLY PREPARED, AND ADEQUATELY SUPPORTED ON AXLE STANDS, ON FIRM LEVEL GROUND, BEFORE ANY OPERATION USING THIS TOOL IS PERFORMED.

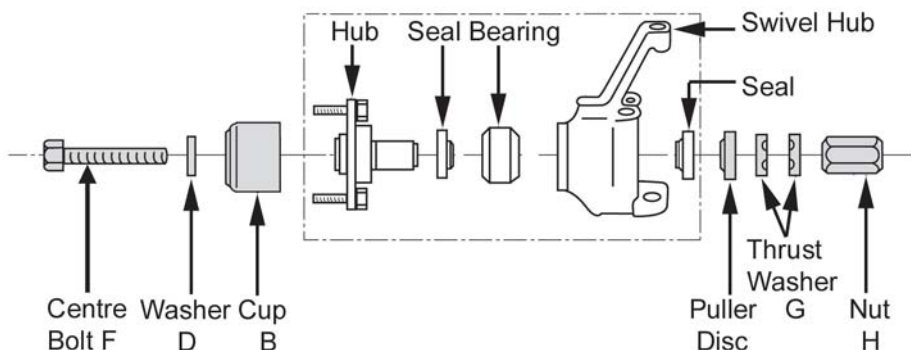

INSTALLING SEALS & BEARINGS

Assemble the parts as shown in the example, selecting the components which fit the job in hand. Ensure the large nut (H) is screwed fully on to the bolt (F), and all components are entirely square before tightening.

HUB PULLING

It is possible to remove a hub from the swivel joint, using the bolts (C) supplied.

The appropriate size bolts are screwed into the holes in the wheel flange, so that they bear up against the surface of the swivel joint.

Screw in the bolts progressively to pull off the hub.

For hubs where the wheel is mounted on studs, a slide hammer type puller must be used.

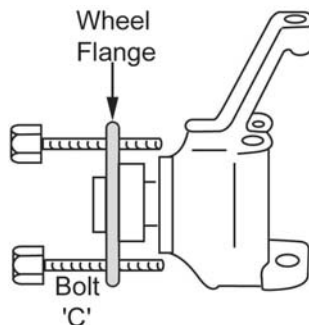

GUARANTEE

This product is guaranteed against faulty manufacture for a period of 12 months from the date of purchase. Please keep your receipt which will be required as proof of purchase.

This guarantee is invalid if the product is found to have been abused or tampered with in any way, or not used for its intended purpose. Faulty goods should be returned to their place of purchase. No product can be returned to us without prior permission. This guarantee does not effect your statutory rights.

A SELECTION FROM THE VAST RANGE OF

Clarke®

QUALITY PRODUCTS

AIR COMPRESSORS

From DIY to industrial, Plus air tools, spray guns and accessories.

GENERATORS

Prime duty or emergency standby for business, home and leisure.

POWER WASHERS

Hot and cold, electric and engine driven - we have what you need

WELDERS

Mig, Arc, Tig and Spot. From DIY to auto/industrial.

METALWORKING

Drills, grinders and saws for DIY and professional use.

WOODWORKING

Saws, sanders, lathes, mortisers and dust extraction.

HYDRAULICS

Cranes, body repair kits, transmission jacks for all types of workshop use.

WATER PUMPS

Submersible, electric and engine driven for DIY, agriculture and industry.

POWER TOOLS

Angle grinders, cordless drill sets, saws and sanders.

STARTERS/CHARGERS

All sizes for car and commercial use.



PARTS & SERVICE: 020 8988 7400

E-mail: Parts@clarkeinternational.com or Service@clarkeinternational.com

SALES: UK 01992 565333 or Export 00 44 (0)1992 565335

Clarke INTERNATIONAL Hemnall Street, Epping, Essex CM16 4LG
www.clarkeinternational.com