

CLAMPBRO®



8 TONNE LOG SPLITTER

MODEL NO: LOGBUSTER 9

PART NO: 3402043

OPERATION & MAINTENANCE INSTRUCTIONS

CE

LS03/16

INTRODUCTION

Thank you for purchasing this CLARKE 8 Tonne Log Splitter.

Before attempting to use this product, please read this manual thoroughly and follow the instructions carefully. In doing so you will ensure the safety of yourself and that of others around you, and you can look forward to your purchase giving you long and satisfactory service.

GUARANTEE

This product is guaranteed against faulty manufacture for a period of 12 months from the date of purchase. Please keep your receipt which will be required as proof of purchase.

This guarantee is invalid if the product is found to have been abused or tampered with in any way, or not used for the purpose for which it was intended.

Faulty goods should be returned to their place of purchase, no product can be returned to us without prior permission.

This guarantee does not effect your statutory rights.

SPECIFICATIONS

	Logbuster 9
Part Number	3402043
Weight	32.1 Kg
Dimensions (D x W x H)	537 x 402 x 1038 mm
Rated Tonnage	8 Tonne
Ram Diameter	38 mm
Ram Length	175 mm
Maximum Log Length	584mm
Minimum Log Length	280 mm
Maximum Log Diameter	230 mm

SAFETY SYMBOLS



**READ
INSTRUCTIONS
BEFORE USE**



**WEAR
SAFETY
GLASSES**



**WEAR
PROTECTIVE
GLOVES**



**WEAR
PROTECTIVE
BOOTS**



**DANGER OF CUTTING OR
CRUSHING OF THE HAND**

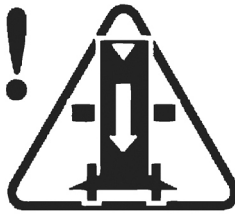

**ALWAYS PAY ATTENTION
TO THE MOVEMENT OF
THE MACHINE**



PROTECT YOUR HANDS

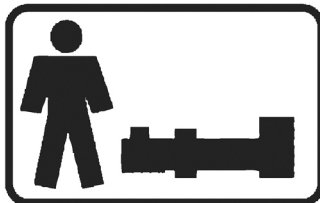

**THIS MACHINE MUST ONLY BE
OPERATED BY ONE PERSON**



**INSPECT THE LOG BUSTER
BEFORE USE FOR
ANY DAMAGE ETC**



**PROTECT THE
ENVIRONMENT**

GENERAL SAFETY RULES



WARNING: READ ALL INSTRUCTIONS. FAILURE TO FOLLOW ALL INSTRUCTIONS LISTED BELOW MAY RESULT IN SERIOUS INJURY.

WARNING: SAVE THESE INSTRUCTIONS.

WORK AREA

1. **Keep the work area clean and well lit.** Cluttered and dark areas invite accidents.
2. **Do not operate the log splitter in explosive atmospheres, such as in the presence of flammable liquids, gases or dust.** The log splitter may create sparks which may ignite the dust or fumes.
3. **Keep children and bystanders away while operating the log splitter.** Distractions can cause you to lose control.
4. **The surface must be perfectly level to prevent the machine from moving during operation.**

PERSONAL SAFETY

1. **Stay alert, watch what you are doing and use common sense when operating a log splitter. Do not use the log splitter while you are tired or under the influence of drugs, alcohol or medication.** A moment of inattention while operating the log splitter may result in serious personal injury.
2. **Use safety equipment. Always wear eye protection.** Safety equipment such as non-skid safety shoes, close fitting clothing and suitable work gloves should always be used.
3. **Do not overreach. Keep proper footing and balance at all times.** This enables better control of the log splitter in unexpected situations.
4. **Dress properly. Do not wear loose clothing or jewellery. Keep your hair, clothing and gloves away from moving parts.** Loose clothes, jewellery or long hair can be caught in moving parts.

USAGE AND CARE

1. **Do not force the log splitter.** It will do the job better and safer at the rate for which it was designed.
2. **Store the log splitter out of the reach of children and do not allow persons unfamiliar with the log splitter or these instructions to operate the log splitter.** Log splitters are dangerous in the hands of untrained users.
3. **Maintain the log splitter. Check for misalignment or binding of moving parts, breakage of parts and any other condition that may affect the operation of the log splitter. If damaged, have the log splitter repaired before use.** Many accidents are caused by poorly maintained tools.

SERVICE

1. **Have your log splitter serviced by a qualified repair person using only identical replacement parts.** This will ensure that safety is maintained.

ADDITIONAL PRECAUTIONS FOR LOG SPLITTERS

- All personnel must read the manual or receive correct training before they use the log splitter.
- Before starting work, check for soundness of welded joints, securing nuts & bolts.
- Examine the hydraulic system for leaks before you start work, Hydraulic fluid can create hazards, causing you to slip and fall, your hands to slip while using the machine, and it is also a potential fire hazard.
- Make sure that the log splitter functions as expected before use.
- NEVER tamper with the log splitter.
- NEVER use the machine whilst under the influence of alcohol, drugs, medicines, or when you are tired. A clear mind is essential for safety.
- The operator must take all necessary precautions to minimise the risk of accidental damage or injury due to wood being ejected from the machine.
- The log splitter is designed for one person operation.
- Do not allow split logs to accumulate; always clean up as you work. Accumulated split logs and wood chips can create a hazardous work environment.
- Split wood in the direction of the grain. Do not attempt to split a piece of wood across the grain as this could seriously damage the machine.
- Please note some particular characteristics of wood when being split. A small log can sometimes be hard to split if it has knots or particularly tough fibres. It is important NOT to persist if the log does not split fairly easily because the pump may be damaged.

ASSEMBLY

ATTACH THE HANDLES

1. Attach a handle to each side of the log splitter.
2. Use the lock washer and hex nut to lock the handgrip in position.

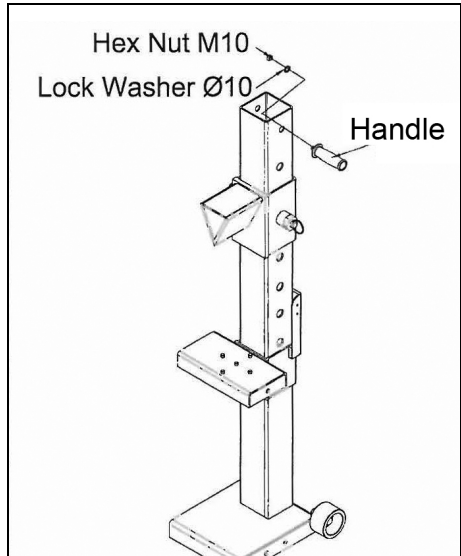

ATTACH THE HYDRAULIC PUMP

1. Use the two inner hex screws supplied to attach the hydraulic pump to the base.

NOTE: Please use the hex wrench supplied.

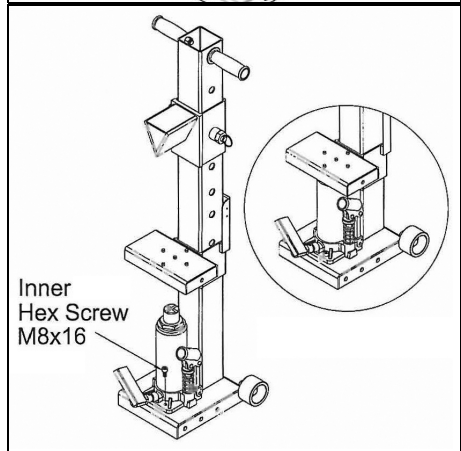

ATTACH THE BASE FEET

1. Carefully lay the Log Splitter on it's back.
2. Attach the stabilisers to each side of the bottom of the log splitter.
3. Use two hex bolts two Lock Washers and two hex nuts. to secure each stabiliser.
4. Lift the Log Splitter in to a vertical position.

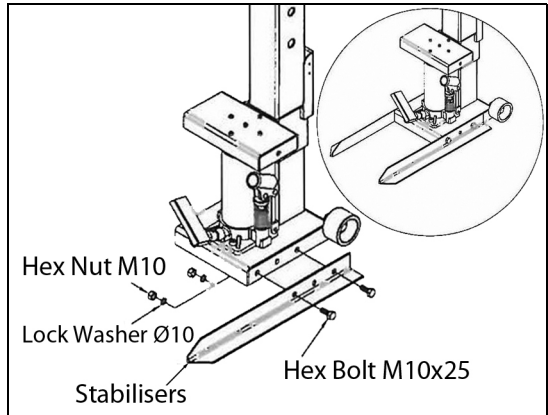

ATTACH THE FOOT PEDAL

1. Engage the foot pedal into the actuating lever.
2. Tighten the hex bolt to secure the foot pedal to the hydraulic pump.

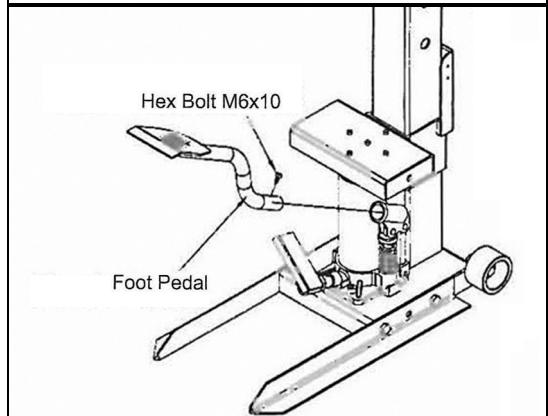

ATTACH TENSION SPRINGS

1. Attach a spring to the center hole on the stabilisers (one each side of the log splitter). Then attach other end of the springs to the log splitter table.

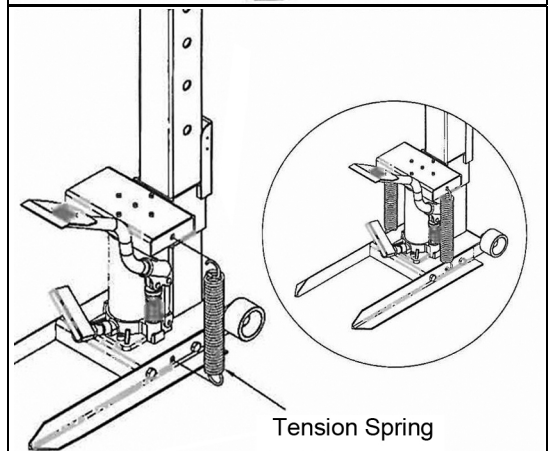

ATTACH THE LOG CRADLE

1. Attach the log cradle to the main post by using hex bolts and lock washers.

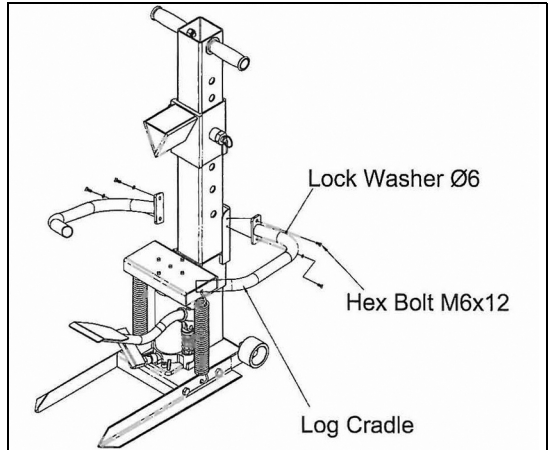

PREPARATION

PREPARING THE LOGS

1. Cut the logs to a suitable length to fit into the log splitter.
2. Put the log on the table.
3. Fix the safety chain to the arms as shown.
 - The safety chain prevents the slit logs from falling towards the operator.
 - During the splitting process, make sure that the logs do not twist or move.
 - Always split the logs in the direction of the grain.
 - Do not place the log across the log splitter for splitting. It is dangerous and can damage the machine.
 - Do not try to split 2 logs at the same time. One of them could fly up and hit you.

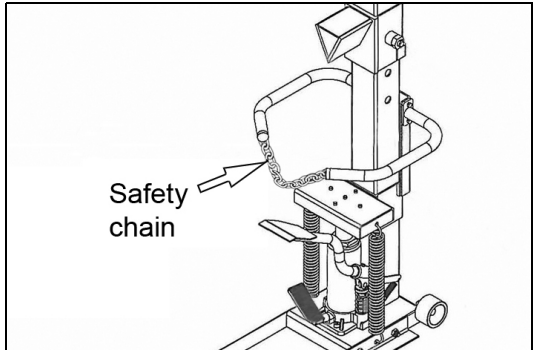

ADJUST THE WEDGE HEIGHT

1. With the log is placed securely on the table, pull and hold the two wedge release pins and lower the wedge to a little higher than the top of the log.
2. Release the pins, making sure they both engage into the nearest post holes.

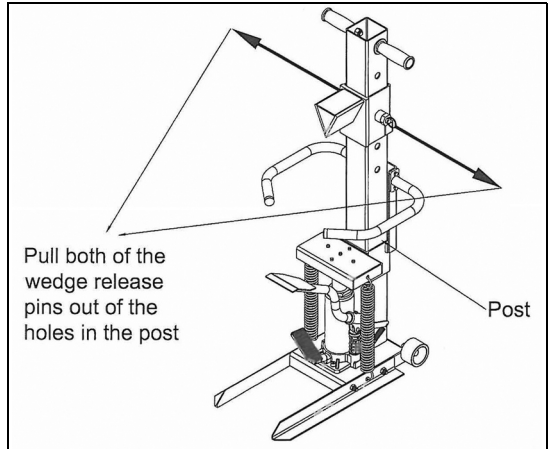

OPERATING THE LOG BUSTER

This Logbuster is designed to be operated by one person only.

- Do not try to split a log that is larger than those shown in the picture.
- Do not put your hands anywhere near the splitting wedge during use.
- Keep your hands away from splits and cracks which open in the log; these can close suddenly and crush your fingers.
- If the log moves away from the wedge, lower the table and turn the log 90° and try again.
- Do not leave the log splitter unattended when the ram is under pressure.

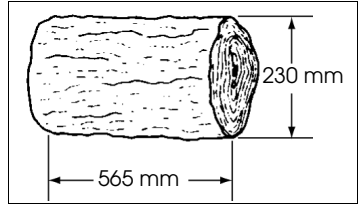

TO SPLIT THE LOG

1. Keeping the log stable and your hands clear, pump the hydraulic foot pedal to raise the log up against the wedge.
2. Continue pumping the foot pedal until the log is split.
 - For hard logs, try to rotate the log by 90° to see if it can be split in a different direction. In any case, if you are still not able to split the log, this means that the wood exceeds the capacity of the machine and should be discarded to protect the log buster.
 - Remove the wood pieces and clear the area of any debris.

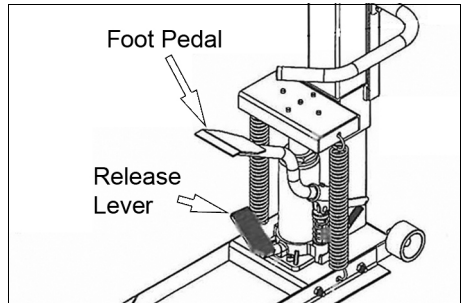

WARNING: NEVER FORCE THE LOG BUSTER FOR MORE THAN 5 SECONDS TO SPLIT EXCESSIVELY HARD WOOD. AFTER THIS TIME, THE OIL UNDER PRESSURE WILL OVERHEAT AND THE MACHINE COULD BE DAMAGED.

TO LOWER THE SPLITTER TABLE

1. Press the release lever with your foot to lower the splitter table.

FREEING A JAMMED LOG

1. Press the release lever with your foot to lower the log splitter table.
2. Tap the top of the log with a rubber mallet to release the log.

MAINTENANCE



WARNING: MAKE SURE THAT THE RAM ON THE LOGBUSTER IS NOT UNDER PRESSURE WHEN YOU ARE CLEANING, MOVING OR MAKING ANY ADJUSTMENTS.

CLEANING

Clean the log splitter with a dry cloth to remove tree sap or dirt after each use.

HOW TO REPLACE THE HYDRAULIC OIL

NOTE: Refer to the parts list and diagram starting on page 13 to identify the parts mentioned in the following text.

1. Remove the tension springs and remove the table from hydraulic pump.
2. Use a 6mm inner hex wrench to remove the two inner hex screws that hold the hydraulic pump to the base.
3. Lay the pump horizontal and remove the oil plug from the rear of the pump.
4. Add hydraulic oil until the cylinder is approximately 3/4 full.

IMPORTANT: Only use CLARKE HYDRAULIC OIL, available from your nearest dealer.

Part No: 1Ltr -3050830

5Ltr -3050835

5. Replace the oil plug and re-assemble the log splitter.

SHARPENING THE WEDGE

After using the log splitter for some time, sharpen the wedge with a fine-toothed file and remove any burrs or crushed area along the cutting edge.

MOVING THE LOG SPLITTER

1. Hold the handles and tilt the log splitter backwards on to its wheels.

TROUBLESHOOTING

PROBLEM	CAUSE	REMEDY
Fails to split logs.	Log is improperly positioned.	Refer to "Operating the Log Buster" on page 10.
	Wedge cutting edge is blunt.	Refer to "Sharpening The Wedge" on page 11.
	Oil leaks.	Contact the Clarke service department.
	Unauthorised adjustment was made to the Maximum Pressure Limiting Screw.	Contact the Clarke service department.
The table moves jerkily.	Excessive air in the hydraulic system.	Check oil level for possible oil refilling. Contact the Clarke service department.
Oil leaks around cylinder ram or from other points.	Air sealed in hydraulic system while operating.	Loosen Bleed Screw by 3- 4 turns before operating the log buster.
	Bleed Screw is not tightened before moving the log buster.	Tighten the Bleed Screw before moving the log buster.
	Oil Drain Cap is not tight.	Tighten the Oil Drain Cap.
	Hydraulic Control Valve assembly and / or seal(s) worn.	Contact the Clarke service department.

EXPLODED DIAGRAM - PARTS LIST

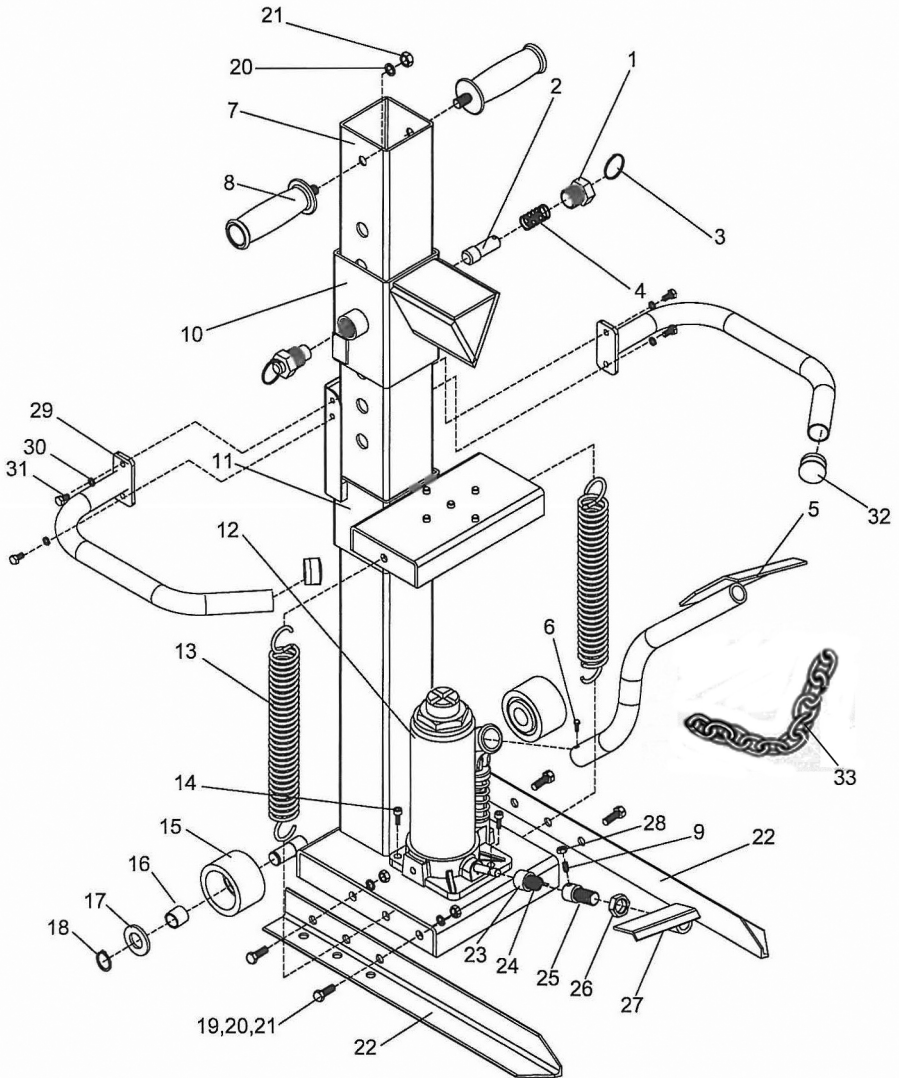

EXPLODED DIAGRAM - PARTS LIST

NO	DESCRIPTION	PART NO
1	Sleeve with Thread	SCLOGB901
2	Pin	SCLOGB902
3	Ring	SCLOGB903
4	Pressure Spring	SCLOGB904
5	Foot Pedal	SCLOGB905
6	Hex Bolt	SCLOGB906
7	Main Post	SCLOGB907
8	Handle	SCLOGB908
9	Inner Hex Screw	SCLOGB909
10	Wedge Assembly	SCLOGB910
11	Table	SCLOGB911
12	Hydraulic Pump	SCLOGB912
13	Tension Spring	SCLOGB913
14	Inner Hex Screw	SCLOGB914
15	Wheel	SCLOGB915
16	Spacer	SCLOGB916
17	Flat Washer	SCLOGB917
18	Circlip	SCLOGB918
19	Hex Bolt	SCLOGB919
20	Lock Washer	SCLOGB920
21	Hex Nut	SCLOGB921
22	Base Feet	SCLOGB922
23	Torsion Spring Sleeve	SCLOGB923
24	Torsion Spring	SCLOGB924
25	Extension Rod	SCLOGB925
26	Thin Nut	SCLOGB926
27	Release Lever	SCLOGB927
28	Hex Nut	SCLOGB928
29	Cradle	SCLOGB929
30	Lock Washer	SCLOGB930
31	Hex Bolt	SCLOGB931
32	End Cover	SCLOGB932
33	Safety Chain and Fixings kit	SCLOGB933

DECLARATION OF CONFORMITY



Clarke[®]
INTERNATIONAL

Hemnall Street, Epping, Essex CM16 4LG

DECLARATION OF CONFORMITY

This is an important document and should be retained.

We hereby declare that this product(s) complies with the following directive(s):

2006/42/EC *Machinery Directive.*

The following standards have been applied to the product(s):

*EN 609-1:1999 +A2:2009, EN 14121-1:2007, EN ISO 12100-1:2003 +A1:2009,
EN ISO 12100-2:2003 +A1:2009.*

The technical documentation required to demonstrate that the product(s) meet(s) the requirement(s) of the aforementioned directive(s) has been compiled and is available for inspection by the relevant enforcement authorities.

The CE mark was first applied in: 2010

Product Description: Log splitter
Model number(s): Logbuster 9
Serial / batch Number: N/A
Date of Issue: 27/01/2015

Signed:

J.A. Clarke
Director

A SELECTION FROM THE VAST RANGE OF

Clarke®

QUALITY PRODUCTS

AIR COMPRESSORS

From DIY to industrial, Plus air tools, spray guns and accessories.

GENERATORS

Prime duty or emergency standby for business, home and leisure.

POWER WASHERS

Hot and cold, electric and engine driven - we have what you need

WELDERS

Mig, Arc, Tig and Spot. From DIY to auto/industrial.

METALWORKING

Drills, grinders and saws for DIY and professional use.

WOODWORKING

Saws, sanders, lathes, mortisers and dust extraction.

HYDRAULICS

Cranes, body repair kits, transmission jacks for all types of workshop use.

WATER PUMPS

Submersible, electric and engine driven for DIY, agriculture and industry.

POWERTOOLS

Angle grinders, cordless drill sets, saws and sanders.

STARTERS/CHARGERS

All sizes for car and commercial use.



PARTS & SERVICE: 0208 988 7400

E-mail: Parts@clarkeinternational.com or Service@clarkeinternational.com

SALES: UK 01992 565333 or Export 00 44 (0)1992 565335

Clarke® INTERNATIONAL Hemnall Street, Epping, Essex CM16 4LG
www.clarkeinternational.com